

Base shoe

1 Plan
1 : 15

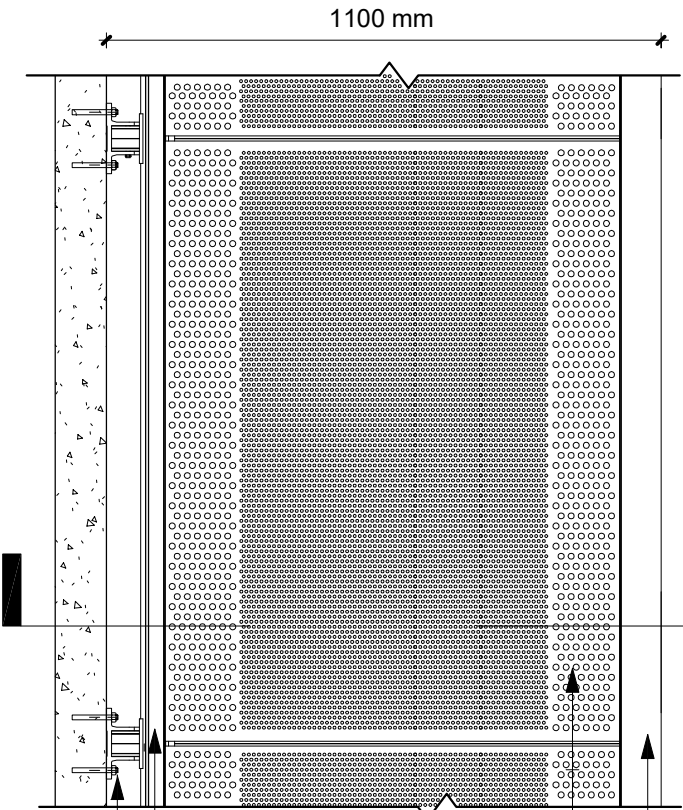

1100 mm

3
R6.1

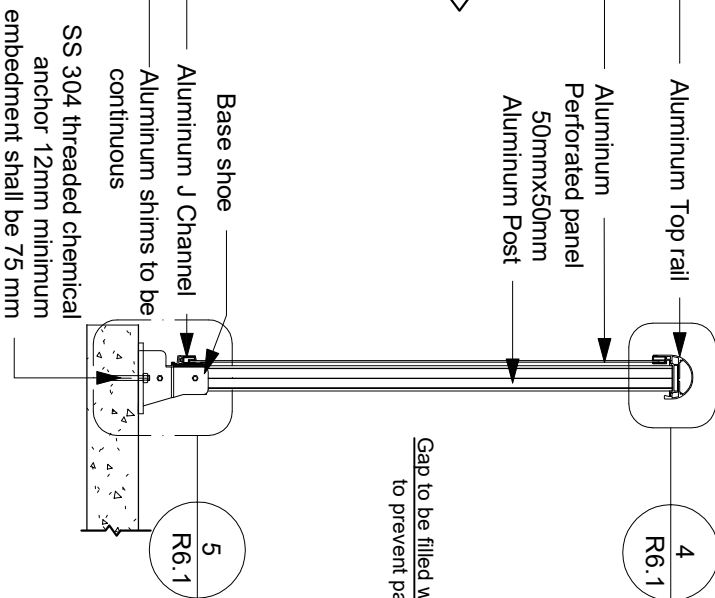

Aluminum Top rail

Aluminum Perforated panel 50mmx50mm

Aluminum Post

Base shoe
Aluminum J Channel

Aluminum shims to be continuous

SS 304 threaded chemical anchor 12mm minimum embedment shall be 75 mm

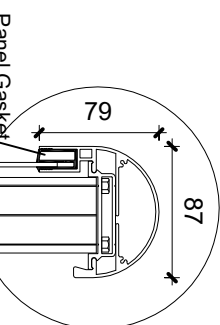

4 Detail 1
1 : 5

87
79

Panel Gasket

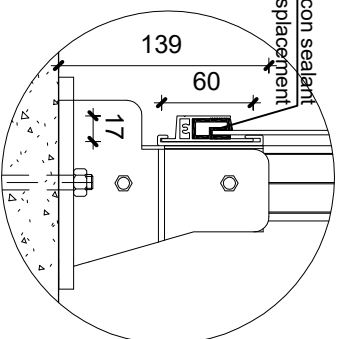

5 Detail 2
1 : 5

139
60
17

Gap to be filled with silicon sealant to prevent panel displacement

2 Front elevation
1 : 15

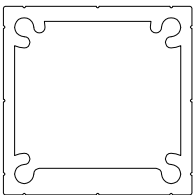

6 LRP001
1 : 2

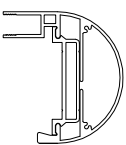

7 LRT101
1 : 5

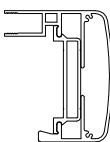

8 LRT102
1 : 5

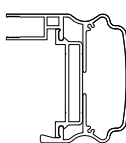

9 LRT103
1 : 5

General Notes

No.	Revision/Issue	Date

Link
RAILINGS
LINK ALUMINIUM RAILING
589, MIDDI EFIELD ROAD,
SCARBOROUGH, ON
linkaluminiumrailings@gmail.com

LRPP-0001 Top Mounted Perforated panel system

Project	Sheet
Date 22-04-2022	R6.1
Scale N.T.S.	